



PLEASE COMPLETELY UNDERSTAND ALL USER INSTRUCTIONS AND SAFETY INFORMATION BEFORE USING THIS PRODUCT. AS WITH ANY HIGH TECH PRODUCT YOU WILL NEED TO ROUTINELY CHECK FOR LOOSE HARDWARE, CRACKS OR OTHER DAMAGE AND REPLACE ITEMS AS NECESSARY. DO NOT USE PRODUCT IF ANY OF THESE CONDITIONS EXIST.

THESE INSTRUCTIONS COVER THE CARE AND USE OF THE FOLLOWING DAWN TO DUSK MODELS: AQUA SHRED, AQUA RIDGE, AND AQUA SUMMIT.

ESSENTIAL MAINTENANCE:

CAUTION: When the bottle shows signs of wear, replace with a new bottle. To prevent excessive wear on the bottle, wipe down any dirt or grit from the bottle cage after riding.

DO NOT FREEZE BOTTLE

HOW TO CLEAN THE BOTTLE

There are three options for cleaning:

1. **DISHWASHER:** Place the bottle on the top rack and the cap in the cutlery compartment. Wash on the Normal cycle.
2. **WASH BY HAND:** Use a small amount of dish soap with warm water. Shake the bottle well and then squeeze the soapy water out through the valve. Rinse thoroughly with cold water and stand the bottle upside down with the cap off to drain and dry.
3. **BAKING SODA AND VINEGAR:** This method will get rid of any odor, mold, or mildew. First, clean the bottle as in method 2 above. Then add 2 tablespoons of baking soda into the bottle and half a cup of vinegar. Allow it to sit for 6-7 minutes and then scrub the inside with a bottle brush (available at most supermarkets). When clean, squirt the contents out through the valve. Next, thoroughly rinse the bottle and cap with fresh cold water and then stand upside down to dry.

WARRANTY

2 year warranty.

Visit www.dawntodusk.bike for warranty details.



PLEASE COMPLETELY UNDERSTAND ALL USER INSTRUCTIONS AND SAFETY INFORMATION BEFORE USING THIS PRODUCT. AS WITH ANY HIGH TECH PRODUCT YOU WILL NEED TO ROUTINELY CHECK FOR LOOSE HARDWARE, CRACKS OR OTHER DAMAGE AND REPLACE ITEMS AS NECESSARY. DO NOT USE PRODUCT IF ANY OF THESE CONDITIONS EXIST.

WARNING: THE **DIRT MASK** WAS DESIGNED TO FIT OUR DAWN TO DUSK **AQUA SHRED, AQUA RIDGE, AQUA SUMMIT** BOTTLES. HOWEVER, THE **DIRT MASK** WILL FIT SEVERAL OTHER MANUFACTURERS' BOTTLES AS WELL. FOR A CURRENT LIST OF COMPATIBLE BOTTLES, PLEASE REFER TO OUR WEBSITE, WWW.DAWNTODUSK.BIKE.

The **DIRT MASK** comes pre-assembled and includes a rubber o-ring for holding the top open.

To Install the **DIRT MASK** on the bottle:

1. Remove the **AQUA CAP** from the bottle.
2. Place the **DIRT MASK** Spacer over the threads of the bottle. Turn the Spacer clockwise if needed so the Spacer is at the bottom of the threads.
3. While **DIRT MASK** is open, place the **DIRT MASK** base over the threads of the bottle until they are on top of the Spacer.
4. Place the **AQUA CAP** back on the threads of the bottle and fully tighten.
5. Close the **DIRT MASK** by pressing down on the top until it snaps closed.

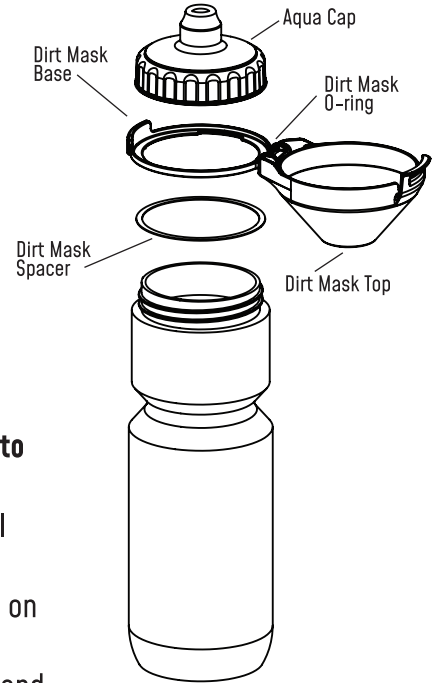

If the rubber o-ring on the **DIRT MASK** is removed or needs to be replaced, use these steps to install a new one:

1. Remove the top piece of the **DIRT MASK** from the base by twisting the top and base until they separate at the hinge.
2. Starting at the hinge of the base, pinch the o-ring and thread one end through the gap on the inside of the hinge. See **Figure A**.
3. Pull the end of the o-ring and place it around the hook on the top surface of the hinge and pull the o-ring tight. See **Figure B**.
4. Re-attach the top piece of the **DIRT MASK** by placing one side of the hinge into the hinge opening on the base, and then twisting the top piece to force the other side of the hinge into the other opening.
5. Pull the loose end of the o-ring and place it around the hook on the top piece of the **DIRT MASK**. See **Figure C**.

WARNING: GRASPING A BOTTLE WITH A **DIRT MASK** IN THE TRADITIONAL MANNER, FROM THE TOP OF THE BOTTLE, YOU MAY EITHER RELEASE THE **DIRT MASK** OR PULL THE **DIRT MASK** OFF OF ITS HINGES. PLEASE REMOVE ANY **DIRT MASK** EQUIPPED BOTTLE BY GRASPING IT AROUND ITS NECK.

ESSENTIAL MAINTENANCE

To clean the **DIRT MASK**, rinse off the dirt and grit from the **DIRT MASK** after riding, this will also prevent wearing on the hinge and o-ring. The **DIRT MASK** can also be placed in the top rack of the dishwasher and washed on the normal cycle.

WARRANTY

DIRT MASK has a 2 year warranty. Visit www.dawntodusk.bike for warranty details.

